

INSTALLATION INSTRUCTIONS

Countertop Soap Dispenser (Theft-Proof Type)
檯面式擠皂器(防竊)安裝說明

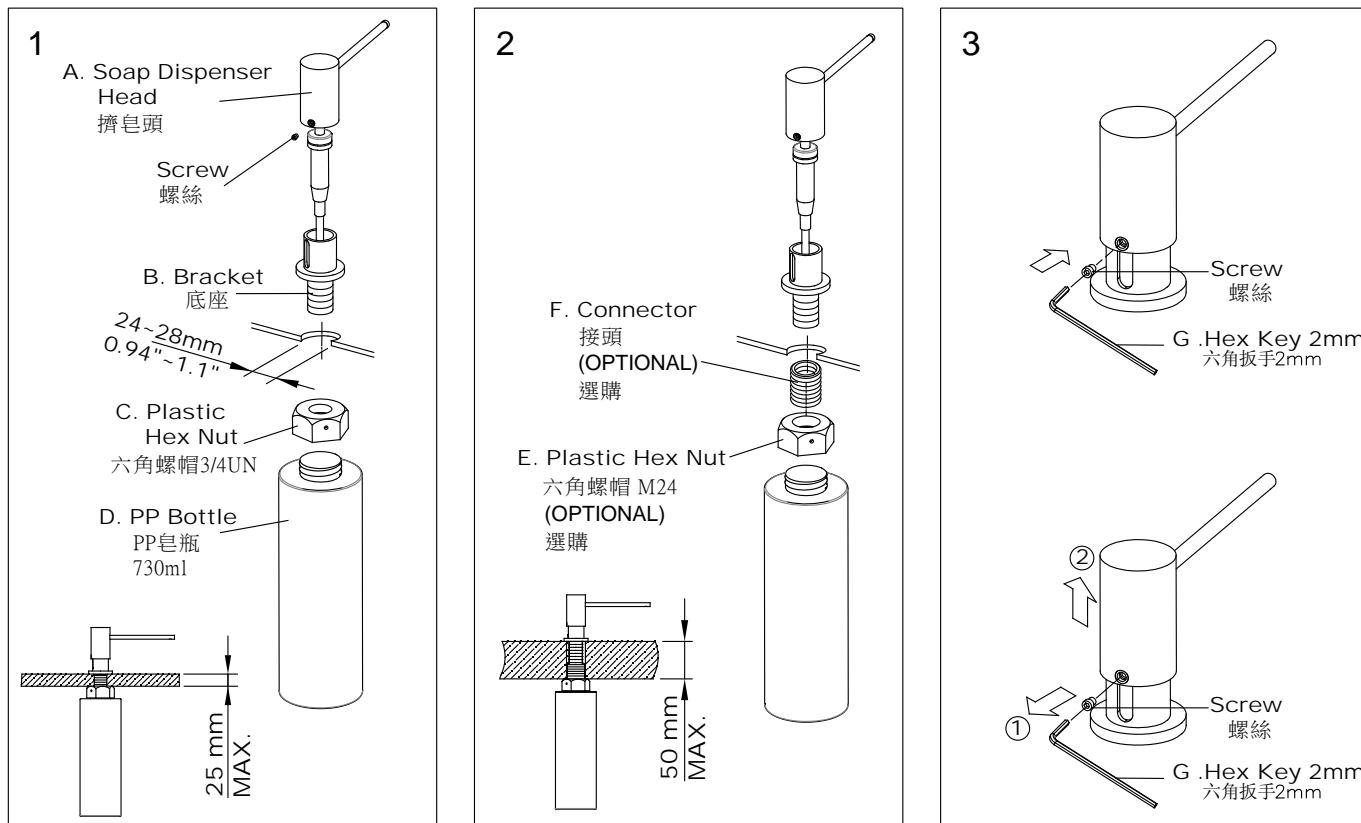

⚠ NOTICE : Mark the proper position and drill a hole with 24~28mm (0.94"~1.1") diameter as the Fig. 1 shows.

注意：請先選取預定安裝的位置,先確認鑽孔的位置,在檯面上鑽孔24~28 mm(0.94"~1.1")如圖示1

1. Place the Bracket through the hole and tighten Plastic Hex Nut to fix it; fill PP Bottle with liquid soap and thread into the Plastic Hex Nut till hand-tight; insert the Soap Dispenser Head in the Bracket.

將底座置入檯面孔內，鎖入六角螺帽；將PP皂瓶填入皂液後鎖到六角螺帽內，再放入擠皂頭。

2. Users could purchase the optional Plastic Hex Nut (M24) and Connector to extend the shank of Bracket for installing on the thicker deck.

為防止檯面厚薄不一,可能發生擠皂器底座不夠長無法組裝,可以選配2多增加一個接頭和六角螺帽,便可增加長度。

3. Aim the screw hole of Soap Dispenser Head to the groove of Bracket, and then fix the Set Screw with Hex Key. Loosen the Set Screw with Hex Key to remove the Soap Dispenser Head

用六角扳手將螺絲鎖入擠皂頭。 ** 注意螺絲孔須對準底座溝處**；若用六角扳手將螺絲鬆開即可拿出擠皂頭。

FIXING CONTENTS

組配件內容

