

Shower Holder
6920-9C-80CP

INTRODUCTION:

JUSTIME made some transformation in oval to increase a sense of modernity, fitting the fashion of this generation, and adding elegant style into 6920 Series.



DESCRIPTION:

- 1.Brass of main body meets the standard of JIS 3604.
- 2.Simple and clean lines improve the surface fineness and reduce the accumulation of dirt.
- 3.Justime finishes resist corrosion and tarnish.
- 4.Chrome plated finish meets the standard of ASTM-SC2.
- 5.Coordinates with other products in 6920 collection.

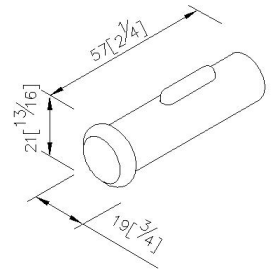

Certification:

unit: mm[inch]

Fixing Kits:

- SUS 304 Stainless Steel Screws*1
- Hex Key 2.5mm*1
- Plastic Anchors*1
- Material of Wall Mount Bracket: Copper JIS3604*1

AWARD: