

Concealed Mixer Valve W/Diverter  
6927-XW-80CP

**INTRODUCTION:**

Designer observed kinds of organisms to sketch contours of product for expounding orderless growth and concept of meristem. Mixer has been combined with stylish handles and organic spout just like to personally experience the pulsation of life. Movable cartridge structure is not only a good solution, but also additional value of products for consumers.



**DESCRIPTION:**

1. Material of brass handle meets JIS 3771 standard.
2. Material of stainless steel faceplate meets SUS 304 standard.
3. Finish meets the standard of ASTM-SC2.
4. Using the C-ring provided if the water pressure is under 1kg/cm<sup>2</sup>(14.2PSI).
5. G1/2 inlet.
6. With replaceable check valve both behind hot and cold water 1/2" inlet.
7. The faucet should be used at the water pressure from 1 to 4 kg/cm<sup>2</sup>.
8. The burying depth of embedded body is between 2"(6cm)Min~3"(7.6cm)Max from the finished wall.
9. Coordinates with other products in Nature collection.

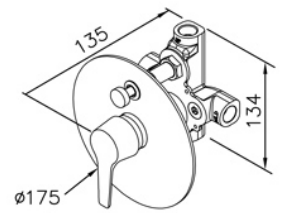

unit:mm

**Certification:**

**Fixing Kits:**

1. SUS 304 Stainless Steel Screws\*1
- Hex Key 2.0mm\*1
- Hex Key 2.5mm\*1
- Set Screw\*1
- Key Tool\*1

**AWARD:**